

**NOTE:**  
THE HOME OWNER IS SOLELY RESPONSIBLE FOR THE DESIGN AND CONSTRUCTION OF ALL FUTURE WORKS AND ANY EFFECT IT SHALL HAVE ON THE EXISTING STRUCTURE.

**NOTE:**  
75mm CONCRETE SLAB TO ENGINEERS DETAIL.

**ROOF CARPENTER NOTE:**  
REFER TO SHEET 3 FOR RANGEHOOD CUT-OUT LOCATION.

**NOTE:**  
EXPANSION JOINTS IN MASONRY WALLS IN ACCORDANCE WITH AS 4773. REFER TO ENGINEERS DETAIL FOR POSITION OF EXPANSION JOINTS.

**NOTE:**  
BUILDER DOES NOT RECOMMEND RELOCATING MANHOLE TO GARAGE DUE TO SECURITY REASONS.

**NOTE:**  
PROVIDE REFLUX VALVE TO SUIT HOBLESS SHOWERS.

AREAS:		
	PERIM. (m)	AREA (m <sup>2</sup> )
HOUSE	57.14	116.88
GARAGE	23.28	32.77
ALFRESCO	14.58	11.12
PORCH	5.06	1.55
		162.32 m <sup>2</sup>
ROOF QUANTITIES		
Material Type	Roof   Metal	
Surface Area (m <sup>2</sup> on the rake)	173.97	
Area (m <sup>2</sup> on the flat)	157.68	

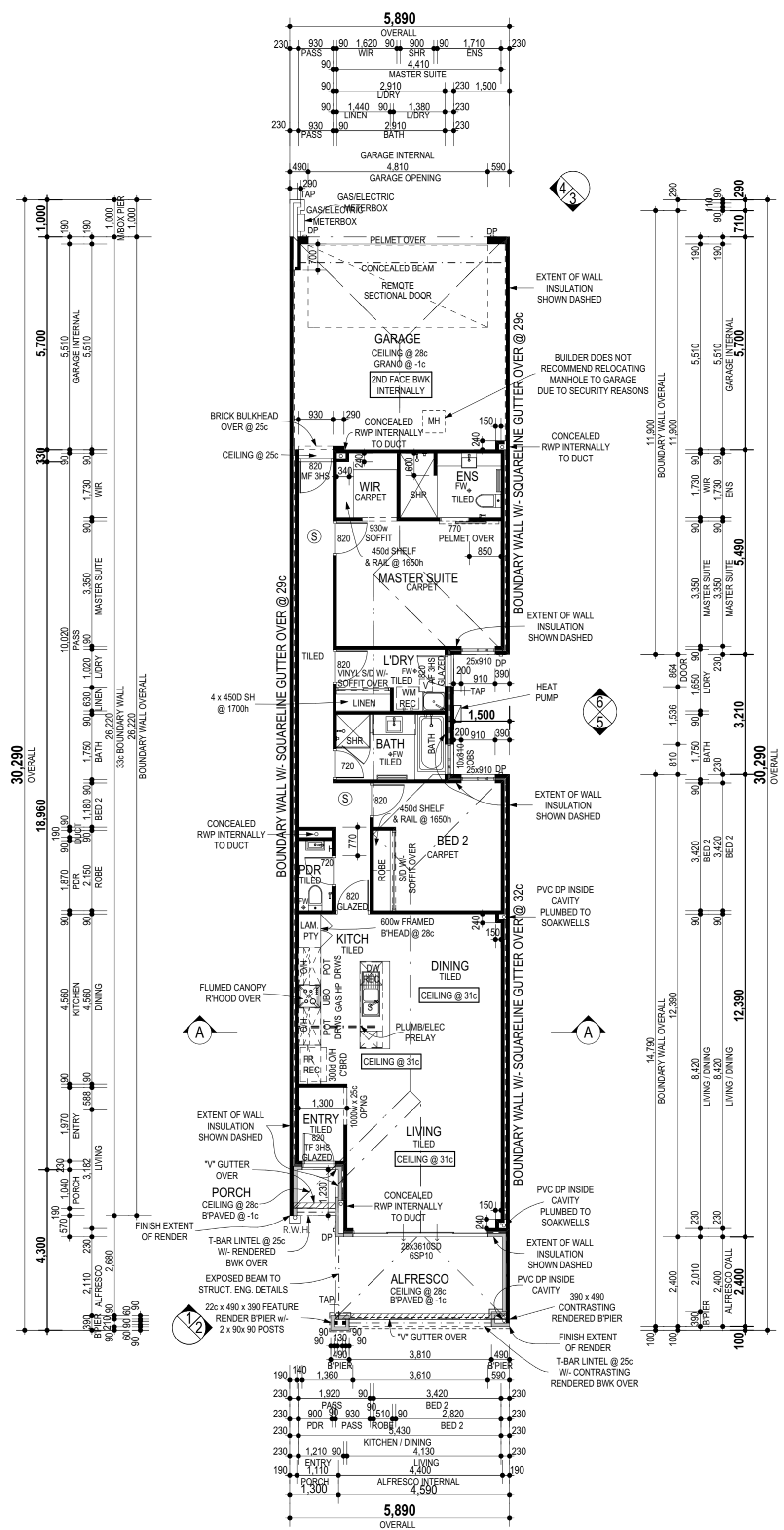

**FLOOR PLAN**  
SCALE 1:100

**NOTE:**  
PROVIDE GTEK "SMARTWALL" PLASTERBOARD TO ALL INTERNAL WALLS

- 6 STAR NOTES:**
- R5.0 BATTS INSULATION TO CEILING AREAS OF HOUSE & GARAGE.
  - EXHAUST FAN TO WET AREAS TO HAVE DRAFT STOPPERS.
  - PROVIDE REFLECTIVE CAVITY INSULATION TO ENTIRE HOME INCLUDING GARAGE CAVITY WALLS.
  - SELECTING A ROOF COLOUR WITH SOLAR ABSORPTANCE GREATER THAN 0.6.
  - UPGRADING GLAZING TO LIVING SLIDING DOOR (28x3610SD) TO 6SP10 GLAZING.

**NOTE:**  
GLAZING CONSTRUCTION AND INSTALLATION TO BE IN 390 2.610 ACCORDANCE WITH AS 1288 (CURRENT) & AS 2047 PIER (CURRENT)

- NOTE:**
- PIER/POST FOOTINGS @ -3c
  - GARAGE FOOTINGS @ -3c
  - GARAGE BOUNDARY WALL FOOTINGS @ -3c
  - HOUSE FOOTINGS @ -2c
  - HOUSE BOUNDARY WALL FOOTINGS @ -2c

**NOTE:**  
230 CAVITY RENDERED BRICKWORK AS SHOWN ON FLOOR PLAN WITH 230 CAVITY FACE BRICKWORK LAID 1/3 BOND TO REMAINDER.

- NOTE:**
- DO NOT SCALE FROM DRAWINGS DIMENSIONS MUST BE FOLLOWED AND CHECKED ON SITE PRIOR TO THE COMMENCEMENT OF THE WORKS.
  - ALL DIMENSIONS SHOWN ON FLOOR PLAN ARE NOMINAL DIMENSIONS ONLY WHICH DO NOT INCLUDE PLASTER/PLASTERBOARD.
  - DOWN PIPES ARE TO BE LOCATED AT PLUMBERS DISCRETION TO SUIT ROOF/WATER VOLUME AND ROOF MEMBERS.
  - FLOOR WASTES/ CEILING VENTS/ MANHOLE SHOWN DIAGRAMMATICALLY ONLY AND MAY BE RELOCATED ON SITE AS REQUIRED
  - ROOF BEAMS ARE SHOWN DIAGRAMMATICALLY ONLY.
  - CL @ 28c THROUGHOUT UNLESS NOTED OTHERWISE.

**TERRACE**

Frank Ferraloro  
0411831183

REVISION	VO #	DRN	DATE	CHK
CONTRACTS		STH	27.10.20	GA
6 STAR AMEND		CY	29.10.20	AP
AMENDMENT		AV	10.11.20	

CLIENT: .....  
DATE: .....  
CLIENT: .....  
DATE: .....  
BUILDER: .....  
DATE: .....

CLIENT:  
ADDRESS:  
( ),  
TUFTS LANE  
AUBIN GROVE

**INDIVIDUAL**

MOMENTUM	
MODEL N°	DATE 10.11.20
MAP REF. N/A	WIND RATING
COASTAL CATEGORY R1	ENGINEERS DETAIL N1
HOME ID 51557	SHEET N° 1 OF 6